

VISOFOLD 1000 ADJUSTABLE JAMB INSTALLATION

FITTING THE OUTER-FRAME

If your outer-frame has not been assembled, please refer to our outer-frame assembly guide first.

If your door comes with a cill or add-on, fix it to the outer-frame before positioning it into the aperture.

Using a spirit level and tape measure, pack every 300mm around the outer-frame making sure it is level and plumb. Use a tape measure to check the diagonals are equal to ensure the outer-frame is square and use a plumb line to check all the sections of the outer-frame are straight and not bowed.

Position the packers either side of the fixing screws so when tightened it doesn't pull the outer-frame and distort it.

Once the door outer-frame is plumb, level and square, fix to the surrounding brick work. We recommend you fix through the thermal break using concrete screws.

FITTING THE SASHES

To fit the adjustable jamb and sashes, position the first sash and jamb as shown in the images below. The jamb will sit onto the ACDV551 adjustable jamb fixings using the pre-drilled holes.

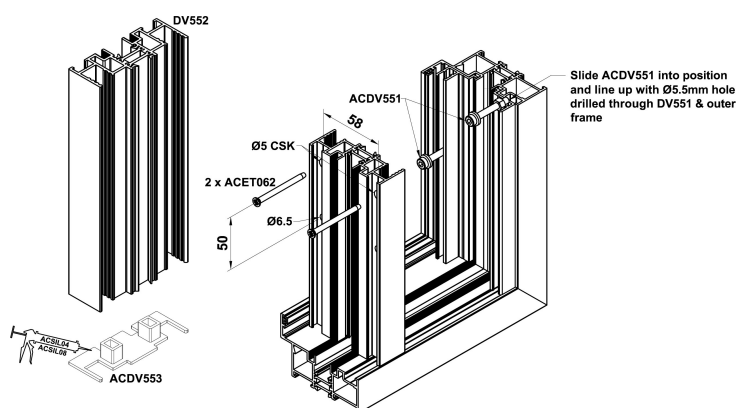
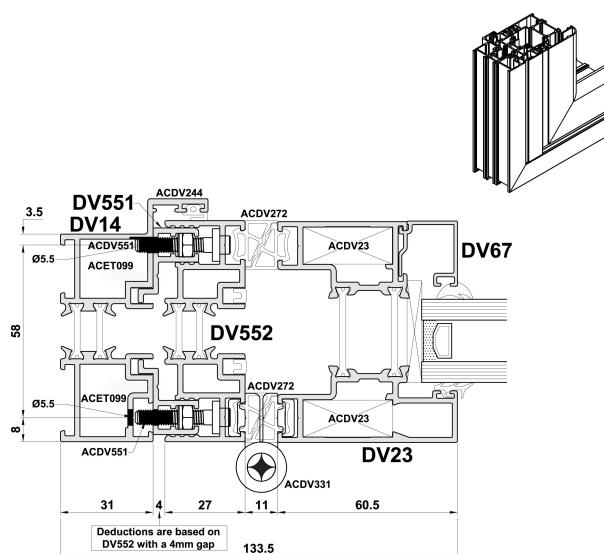

Using the ACET062 Screws supplied, fix the adjustable jamb to the outer-frame using the pre-drilled fixing holes.

To fit the rest of the sashes, position each sash in turn into the outerframe and re-attach using the machine screws supplied.

The central self tapping screw should be fitted after the glass is fitted and this is shown later on in this installation guide.

GLAZING AND TOE & HEALING

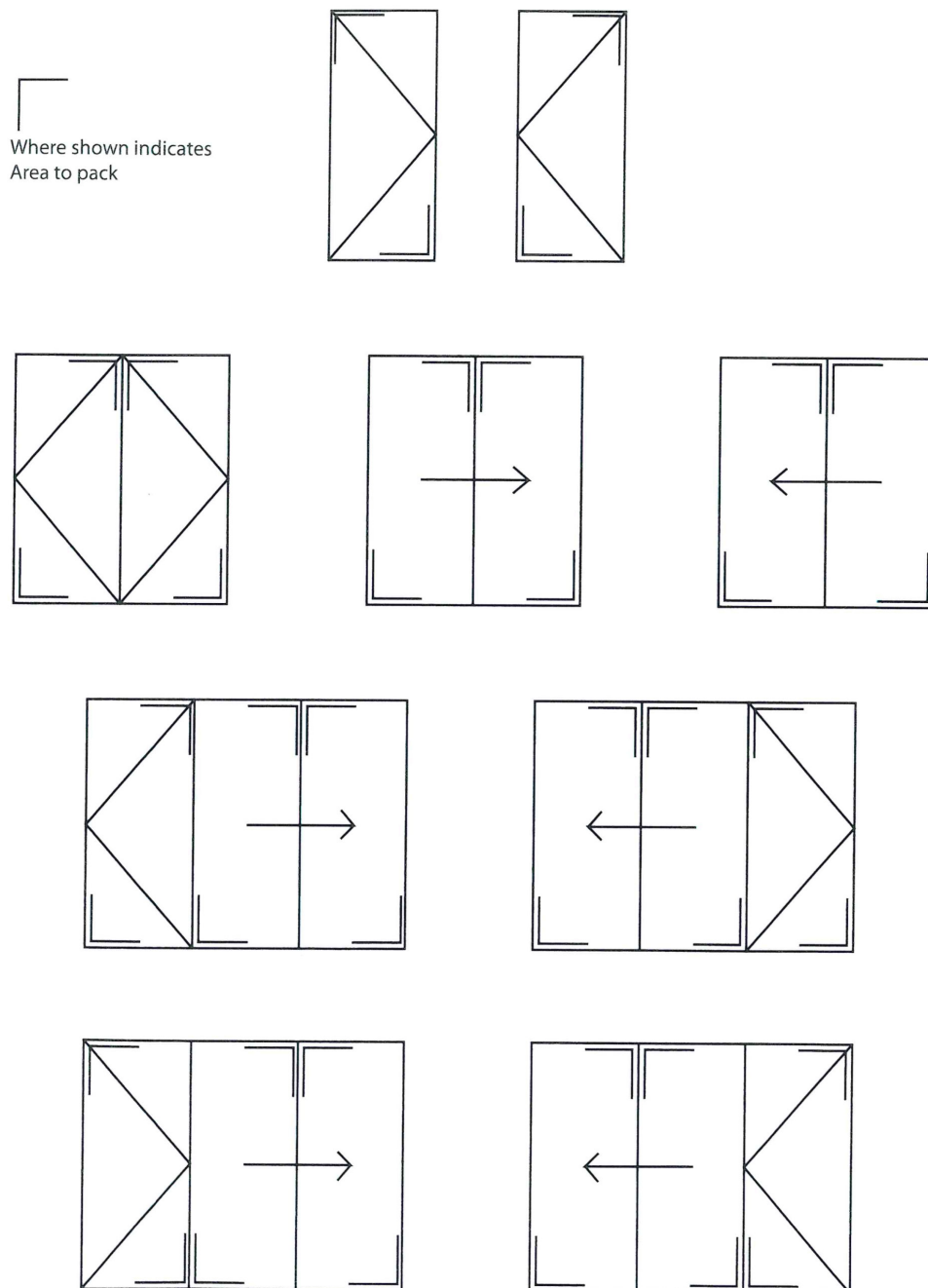

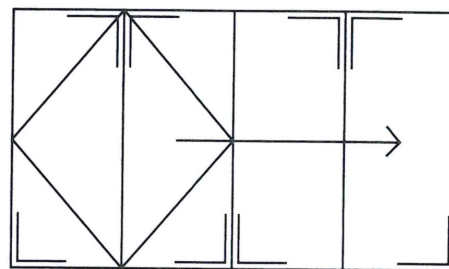
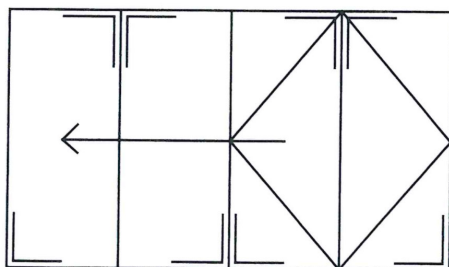
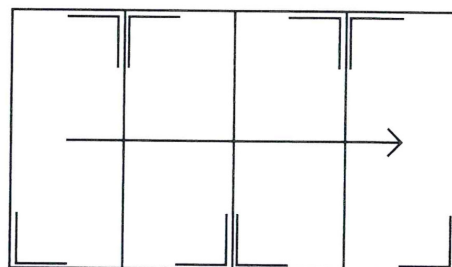
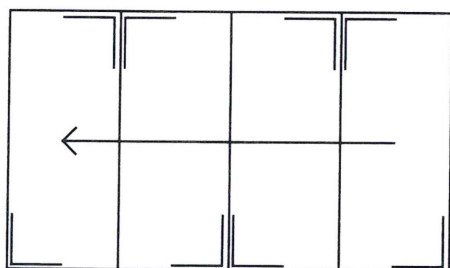
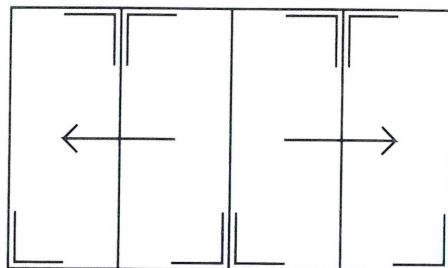

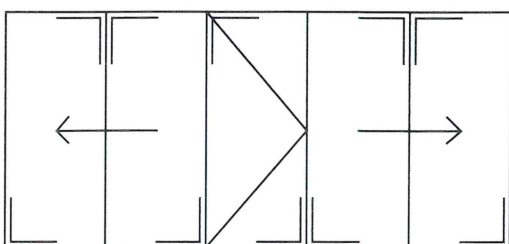
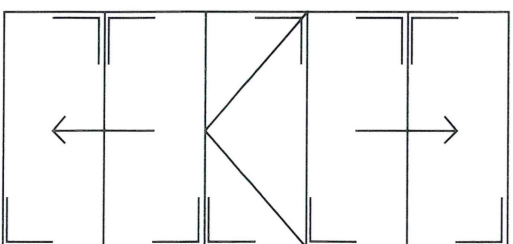
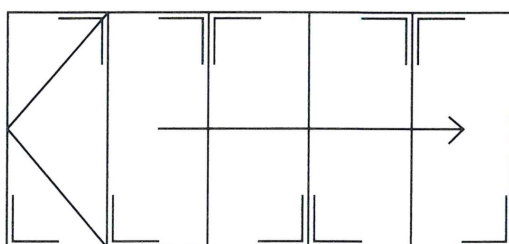
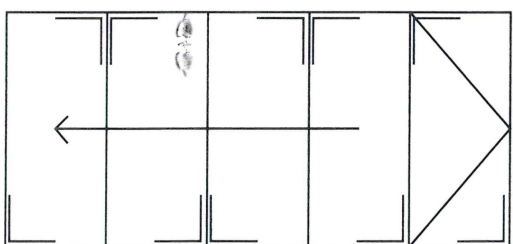
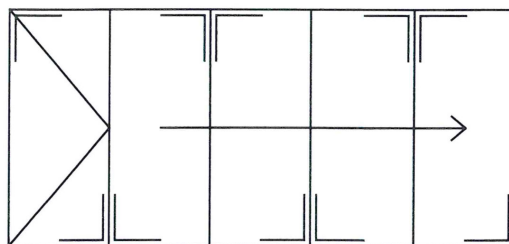
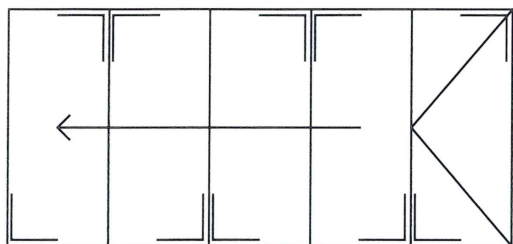

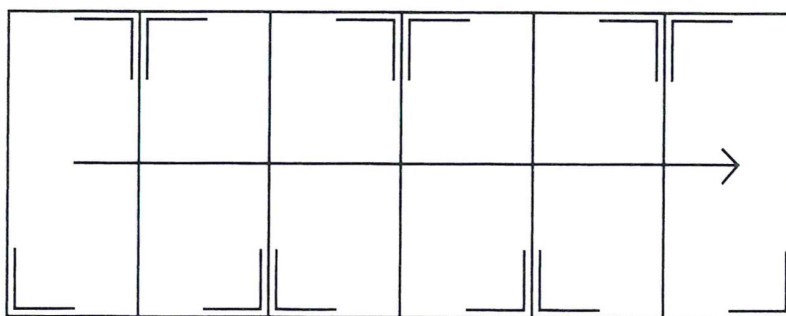
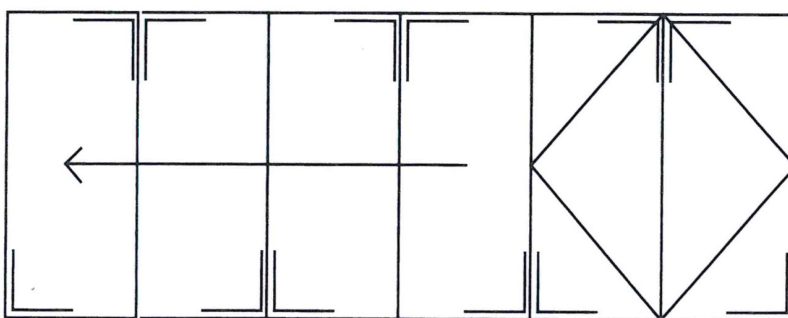
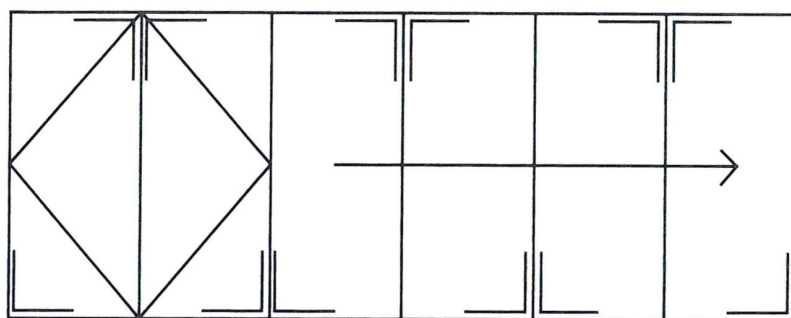
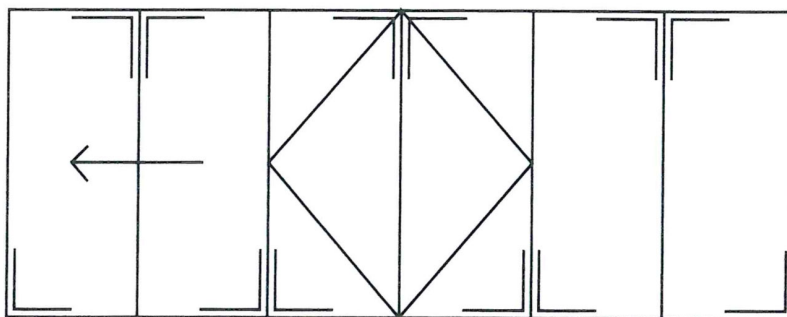

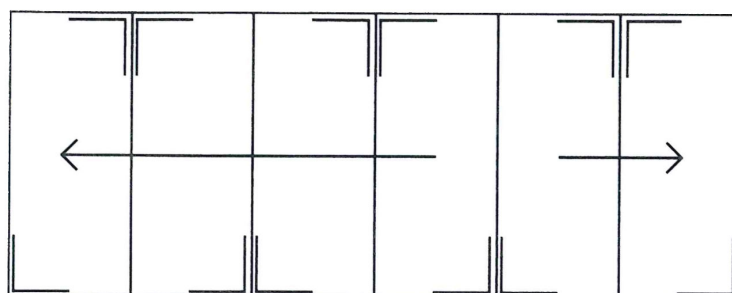
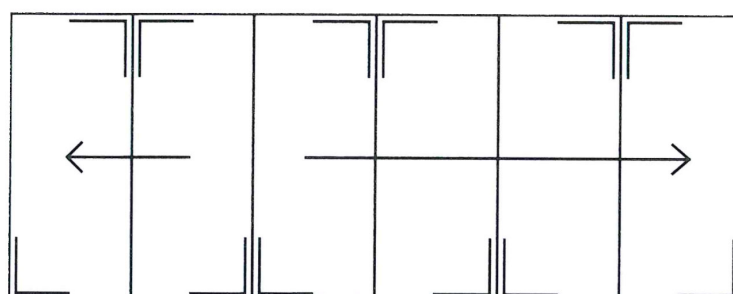
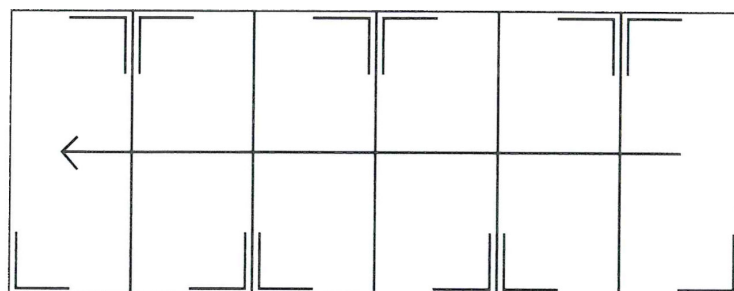



FINAL FIXINGS

After you have toe and healed each sash and checked the operation, you will need to fit the glazing beads. To do this replace them in the same order they were removed and secure by fitting the glazing tear off gasket supplied.

Once glazed and the operation is tested you need to fix hinges to the sash / outer-frame using the self tapping screws provided.

To stop the traffic door from swinging in the wind when open, there is a magnetic catch supplied.

Following the instructions in the magnetic catch box, install on half 165mm in and 30mm down on the top of the opening end of the traffic door.

Install the other half in the same manner on the sash next to the traffic door so when fully open the two halves connect.